

角接触轴承

Angular contact bearing

STPM[®]

内径30~90mm

Bore diameter 12~90mm

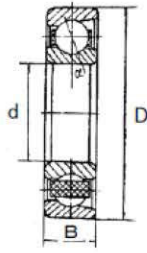

单列

主要尺寸(mm) Dimensions			轴承型号 Bearing NO.	接触角 α Type of Angles		
内径 d	外径 D	厚度 B		15° / 精度	25° / 精度	40°
30	62	16	7206	C	AC/P5	-
	72	19	7306	C	AC	-
	90	23	7406	-	AC	-
35	72	17	7207	C	AC/P5	-
	80	21	7307	C/P6	AC/P6	-
	100	25	7407	-	AC	-
40	68	15	7008	-	AC	-
	80	18	7208	C	AC/P5	-
	90	23	7308	C	AC/P5	-
	110	27	7408	-	AC	-
45	75	16	7009	C	AC	-
	85	19	7209	C	AC/P5	-
	100	25	7309	C	AC/P5	-
	120	29	7409	-	AC	-
50	80	16	7010	C	AC	-
	90	20	7210	C	AC/P5	-
	110	27	7310	C	AC/P5	-
	130	31	7410	-	AC	-
55	90	18	7011	C	AC	-
	100	21	7211	C	AC	-
	120	29	7311	C	AC	-
60	95	18	7012	C	AC	-
	110	22	7212	C	AC	-
	130	31	7312	C	AC	-
	100	18	7013	C	AC	-
65	120	23	7213	C	AC	-
	140	33	7313	C	AC	-
70	110	20	7014	C	AC	-
	125	24	7214	C	AC	-
	150	35	7314	C	AC	-
75	130	25	7215	C	AC	-
	160	37	7315	C	AC	-
80	140	26	7216	C	AC	-
	170	39	7316	C	AC	-
85	150	28	7217	C	AC	-
	180	41	7317	C	AC	-
90	140	24	7018	C	AC	-
	160	30	7218	C	AC	-

角接触轴承

Angular contact ball bearings

STPM®

内径10~100mm

Bore diameter 10~100mm

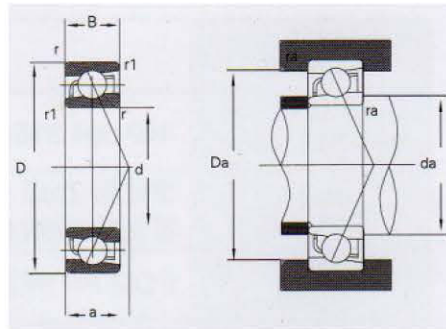

轴承型号 Bearing NO.	外形尺寸 (mm) Boundary dimension (mm)				额定负荷 Load Rating		重量Mass (参考)(refer)) (Kg)
	d	D	B	r最小(min)	Cr	Cor	
5200	10	30	14.3	0.6	6.95	3.8	0.049
5201	12	32	15.9	0.6	9.15	5.05	0.057
5202	15	35	15.9	0.6	10	6.05	0.064
5203	17	40	17.5	0.6	12.8	7.9	0.096
5204	20	47	20.6	1	19	12.1	0.153
5205	25	52	20.6	1	20.6	14.3	0.175
5206	30	62	23.8	1	28.6	20.4	0.286
5207	35	72	27	1.1	38	27.8	0.436
5208	40	80	30.2	1.1	42.5	32.5	0.59
5209	45	85	30.2	1.1	48	37	0.64
5210	50	90	30.2	1.1	51	42	0.689
5211	55	100	33.3	1.5	63	53	0.986
5212	60	110	36.5	1.5	71.5	58.5	1.27
5213	65	120	38.1	1.5	83.5	72.5	1.57
5214	70	125	39.7	1.5	90.5	79.5	1.8
5215	75	130	41.3	1.5	90	80.5	1.9
5216	80	140	44.4	2	106	95.5	2.39
5217	85	150	49.2	2	112	106	3.06
5218	90	160	52.4	2	140	129	3.73
5219	95	170	55.6	2.1	159	148	4.86
5220	100	180	60.3	2.1	178	167	5.94

角接触轴承

Angular contact ball bearings

STPM[®]

内径15~75mm

Bore diameter 15~75mm

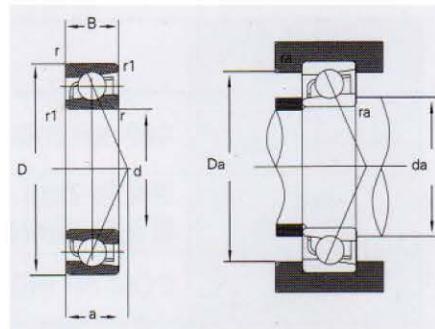

轴承型号 Bearing NO.	外形尺寸 (mm) Boundary dimension(mm)				额定负荷 Load Rating		重量Mass (参考)(refer)) (Kg)
	d	D	B	r最小(min)	Cr	Cor	
5302	15	42	19	1	17.2	10.1	0.132
5303	17	47	22.2	1	20.4	12.1	0.181
5304	20	52	22.2	1.1	20.6	12.7	0.217
5305	25	62	25.4	1.1	30.5	20.5	0.362
5306	30	72	30.2	1.1	39.5	27.5	0.553
5307	35	80	34.9	1.5	49.5	35	0.766
5308	40	90	36.5	1.5	60.5	44	1.01
5309	45	100	39.7	1.5	72.5	54	1.34
5310	50	110	44.4	2	85.5	64.5	1.81
5311	55	120	49.2	2	106	82	2.32
5312	60	130	54	2.1	122	95.5	3.05
5313	65	140	58.7	2.1	138	109	3.96
5314	70	150	63.5	2.1	155	125	4.74
5315	75	160	68.3	2.1	168	141	5.65

角接触轴承

Angular contact ball bearings

STDM®

内径10~45mm

Bore diameter 10~45mm

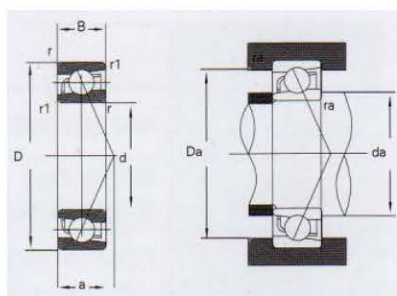

材料 Material	
不锈钢材 stainless steel	420 440 316
陶瓷 Ceramic	氧化锆ZrO2 氧化硅Si3N4

轴承型号 Bearing NO.	外形尺寸 (mm) Boundary dimension (mm)					有关安装尺寸			重量 Mass (Kg) (参考) (refer))		
	d	D	B	r 最小(min)	r1 最小(min)	da	Da	ra	440	ZrO2	Si3N4
						最小(min)	最大(max)	最大(max)			
7900	10	22	6	0.3	0.15	12.5	19.5	0.3	0.009	0.007	0.0038
7000		26	8	0.3	0.15	12.5	23.5	0.3	0.018	0.014	0.0075
7200		30	9	0.6	0.3	15	25	0.6	0.032	0.025	0.013
7300		35	11	0.6	0.3	15	30	0.6	0.052	0.040	0.022
7901	12	24	6	0.3	0.15	14.5	21.5	0.3	0.01	0.008	0.0042
7001		28	8	0.3	0.15	14.5	25.5	0.3	0.022	0.017	0.0092
7201		32	10	0.6	0.3	17	27	0.6	0.037	0.028	0.015
7301		37	12	1	0.6	18	31	1	0.06	0.046	0.025
7902	15	28	7	0.3	0.15	17.5	25.5	0.3	0.015	0.012	0.0063
7002		32	9	0.3	0.15	17.5	29.5	0.3	0.031	0.024	0.013
7202		35	11	0.6	0.3	20	30	0.3	0.045	0.035	0.019
7302		42	13	1	0.6	21	36	1	0.083	0.046	0.035
7903	17	30	7	0.3	0.15	19.5	27.5	0.3	0.017	0.013	0.0071
7003		35	10	0.3	0.15	19.5	32.5	0.3	0.041	0.032	0.017
7203		40	12	0.6	0.3	22	35	0.6	0.067	0.052	0.028
7303		47	14	1	0.6	23	41	1	0.113	0.087	0.047
7904	20	37	9	0.3	0.15	22.5	34.5	0.3	0.037	0.028	0.015
7004		42	12	0.6	0.3	25	37	0.6	0.068	0.052	0.028
7204		47	14	1	0.6	26	41	1	0.107	0.082	0.045
7304		52	15	1.1	0.6	27	45	1	0.145	0.11	0.060
7905	25	42	9	0.3	0.15	27.5	39.5	0.3	0.042	0.032	0.018
7005		47	12	0.6	0.3	30	42	0.6	0.079	0.061	0.033
7205		52	15	1	0.6	31	46	1	0.129	0.099	0.054
7305		62	17	1.1	0.6	32	55	1	0.235	0.18	0.098
7906	30	47	9	0.3	0.15	32.5	44.5	1	0.052	0.040	0.022
7006		55	13	1	0.6	36	49	1	0.116	0.089	0.048
7206		62	16	1	0.6	36	56	1	0.199	0.015	0.083
7306		72	19	1.1	0.6	37	65	1	0.345	0.27	0.14
7907	35	55	10	0.6	0.3	40	50	0.6	0.075	0.058	0.031
7007		62	14	1	0.6	41	56	1	0.151	0.12	0.063
7207		72	17	1.1	0.6	42	65	1	0.284	0.22	0.12
7307		80	21	1.5	1	44	71	1.5	0.464	0.36	0.19
7908	40	62	12	0.6	0.3	45	57	0.6	0.112	0.09	0.05
7008		68	15	1	0.6	46	62	1	0.19	0.15	0.08
7208		80	18	1.1	0.6	47	73	1	0.366	0.28	0.15
7308		90	23	1.5	1	49	81	1.5	0.636	0.49	0.27
7909	45	68	12	0.6	0.3	50	63	0.6	0.126	0.097	0.053
7009		75	16	1	0.6	51	69	1	0.241	0.19	0.100
7209		85	19	1.1	0.6	52	78	1	0.42	0.32	0.175
7309		100	25	1.5	1	54	91	1.5	0.829	0.64	0.345

角接触轴承

Angular contact ball bearings

STDM[®]

内径50~110mm

Bore diameter 50~110mm

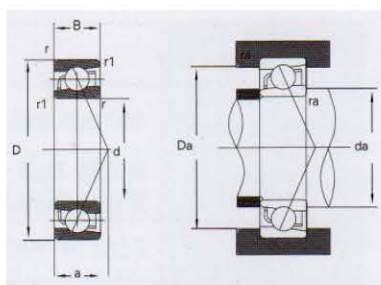

材料 Material	
不锈钢材 stainless steel	420 440 316
陶瓷 Ceramic	氧化锆 ZrO ₂ 氧化硅 Si ₃ N ₄

轴承型号 Bearing NO.	外形尺寸 (mm) Boundary dimension (mm)					有关安装尺寸			重量 Mass (Kg) (参考) (refer))		
	d	D	B	r 最小(min)	r1 最小(min)	da	Da	ra	440	ZrO ₂	Si ₃ N ₄
						最小(min)	最大(max)	最大(max)			
7910	50	72	12	0.6	0.3	55	67	0.6	0.135	0.10	0.06
7010		80	16	1	0.3	56	74	1	0.261	0.20	0.11
7210		90	20	1.1	0.6	57	83	1	0.459	0.35	0.19
7310		110	27	2	1	60	100	2	1.06	0.82	0.44
7911	55	80	13	1	0.6	61	74	1	0.189	0.15	0.08
7011		90	18	1.1	0.6	62	83	1	0.381	0.29	0.16
7211		100	21	1.5	1	64	91	1.5	0.619	0.48	0.26
7311		120	29	2	1	65	110	2	1.37	1.05	0.57
7912	60	85	13	1	0.6	66	79	1	0.192	0.15	0.08
7012		95	18	1.1	0.6	67	88	1	0.412	0.32	0.17
7212		110	22	1.5	1	69	101	1.5	0.783	0.60	0.33
7312		130	31	2.1	1.1	72	118	2	1.72	1.32	0.72
7913	65	90	13	1	0.6	71	84	1	0.218	0.17	0.09
7013		100	18	1.1	0.6	72	93	1	0.439	0.34	0.18
7213		120	23	1.5	1	74	111	1.5	1	0.77	0.42
7313		140	33	2.1	1.1	77	128	2	2.11	1.62	0.88
7914	70	100	16	1	0.6	76	94	1	0.349	0.27	0.15
7014		110	20	1.1	0.6	77	103	1	0.608	0.47	0.25
7214		125	24	1.5	1	79	116	1.5	10.9	0.84	0.45
7314		150	35	2.1	1.1	82	138	2	2.57	1.98	1.07
7915	75	105	16	1	0.6	81	99	1	0.364	0.28	0.15
7015		115	20	1.1	0.6	82	108	1	0.649	0.50	0.27
7215		130	25	1.5	1	84	121	1.5	1.19	0.92	0.50
7916	80	110	16	1	0.6	86	104	1	0.391	0.30	0.16
7016		125	22	1.1	0.6	87	118	1	0.872	0.67	0.36
7216		140	26	2	1	90	130	2	1.42	1.09	0.59
7017	85	130	22	1.1	0.6	92	123	1	0.918	0.71	0.38
7217		150	28	2	1	95	140	2	1.76	1.35	0.73
7918	90	128	18	1.1	0.6	97	118	1	0.585	0.45	0.24
7019		140	24	1.5	1	99	131	1.5	1.19	0.92	0.50
7919	95	130	18	1.1	0.6	102	123	1	0.601	0.46	0.25
7019		145	24	1.5	1	104	136	1.5	1.23	0.95	0.51
7920	100	140	20	1.1	0.6	107	133	1	0.828	0.64	0.35
7020		150	24	1.5	1	109	141	1.5	1.29	0.99	0.54
7921	105	145	20	1.1	0.6	112	138	1	0.856	0.66	0.36
7922	110	150	20	1.1	0.6	117	143	1	0.893	0.69	0.37

角接触轴承

Angular contact ball bearings

STPM®

内径30~100mm

Bore diameter 30~100mm



轴承型号 Bearing NO.	外形尺寸 (mm) Boundary dimension (mm)			额定负荷 (kN) Load Rating		极限转速 (rpm) Limited Speed		重量Mass (参考) (refer) (Kg)
	d	D	B	Cr	Cor	Grease	Oil	
	QJ206	30	62	16	30.0	21.6	6800	
QJ306	72		19	43.1	30.8	6000	7500	0.480
QJ207	35	72	17	31.3	27.0	6500	7200	0.360
QJ307		80	21	48.5	41.6	6000	6600	0.580
QJ208	40	80	18	36.1	32.0	6100	6700	0.400
QJ308		90	23	61.3	56.5	5900	6400	0.850
QJ209	45	85	19	39.2	35.2	5800	6600	0.450
QJ309		100	25	73.1	68.2	5700	6300	0.940
QJ210	50	90	20	49.0	45.0	4800	5500	0.520
QJ310		110	27	76.5	72.2	4600	6200	1.280
QJ211	55	100	21	55.3	53.5	4500	6000	0.750
QJ311		120	29	88.9	75.6	3800	5100	1.700
QJ212	60	110	22	64.6	60.5	4100	5300	1.000
QJ312		130	31	102.2	87.5	3600	4700	2.100
QJ213	65	120	23	72.8	72.8	3600	4700	1.200
QJ313		140	33	115.5	102.2	3400	4500	2.700
QJ214	70	125	24	79.8	79.8	3600	4700	1.300
QJ314		150	35	130.2	116.2	3100	4100	3.100
QJ215	75	130	25	81.9	85.4	3400	4500	1.450
QJ315		160	37	139.3	130.2	2900	3800	3.800
QJ216	80	140	26	96.6	102.2	3200	4000	1.800
QJ316		170	39	151.2	145.6	2700	3600	4.600
QJ217	85	150	28	103.6	112.0	2900	3800	2.200
QJ317		180	41	163.8	165.2	2500	3400	5.500
QJ218	90	160	30	121.8	130.2	2700	3600	2.700
QJ318		190	43	185.5	199.5	2400	3200	6.400
QJ219	95	170	32	139.3	148.4	2500	3400	3.300
QJ319		200	45	200.2	220.5	2200	3000	7.300
QJ220	100	180	34	157.5	168.0	2400	3200	4.000
QJ320		215	47	214.9	238.0	2000	2900	9.200

角接触轴承

Angular contact bearing



内径25~100mm

Bore diameter 25~90mm



组合式

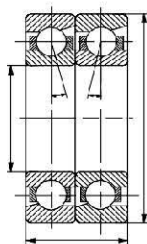

正面

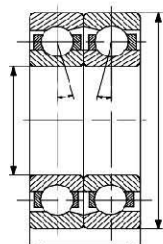

并列

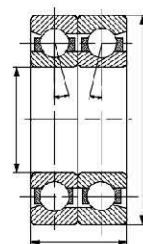

背面

主要尺寸(mm) Dimensions			轴承型号 Bearing NO.	角接触种类 α Type of bearings and angles								
内径 d	外径 D	厚度 B		正面 (DF)			并列 (DT)			背面 (DB)		
				15°	25°	40°	15°	25°	40°	15°	25°	40°
25	47	24	7005	C/DF	AC/DF	-	C/DT	AC/DT	-	C/DB	AC/DB	-
	52	30	7205	C/DF	AC/DF	B/DF	C/DT	AC/DT	B/DT	C/DB	AC/DB	B/DB
	62	34	7305	C/DF	AC/DF	B/DF	C/DT	AC/DT	B/DT	C/DB	AC/DB	B/DB
30	55	26	7006	C/DF	AC/DF	-	C/DT	AC/DT	-	C/DB	AC/DB	-
	62	32	7206	C/DF	AC/DF	B/DF	C/DT	AC/DT	B/DT	C/DB	AC/DB	B/DB
	72	38	7306	C/DF	AC/DF	B/DF	C/DT	AC/DT	B/DT	C/DB	AC/DB	B/DB
35	62	28	7007	C/DF	AC/DF	-	C/DT	AC/DT	-	C/DB	AC/DB	-
	72	34	7207	C/DF	AC/DF	B/DF	C/DT	AC/DT	B/DT	C/DB	AC/DB	B/DB
	80	42	7307	C/DF	AC/DF	B/DF	C/DT	AC/DT	B/DT	C/DB	AC/DB	B/DB
40	68	30	7008	C/DF	AC/DF	-	C/DT	AC/DT	-	C/DB	AC/DB	-
	80	36	7208	C/DF	AC/DF	B/DF	C/DT	AC/DT	B/DT	C/DB	AC/DB	B/DB
				C/DF	AC/DF	B/DF	C/DT	AC/DT	B/DT	C/DB	AC/DB	B/DB
45	75	32	7009	C/DF	AC/DF	-	C/DT	AC/DT	-	C/DB	AC/DB	-
	85	38	7209	C/DF	AC/DF	B/DF	C/DT	AC/DT	B/DT	C/DB	AC/DB	B/DB
	100	50	7309	C/DF	AC/DF	B/DF	C/DT	AC/DT	B/DT	C/DB	AC/DB	B/DB
50	80	32	7010	C/DF	AC/DF	-	C/DT	AC/DT	-	C/DB	AC/DB	-
	90	40	7210	C/DF	AC/DF	B/DF	C/DT	AC/DT	B/DT	C/DB	AC/DB	B/DB
	110	54	7310	C/DF	AC/DF	B/DF	C/DT	AC/DT	B/DT	C/DB	AC/DB	B/DB
55	90	36	7011	C/DF	AC/DF	-	C/DT	AC/DT	-	C/DB	AC/DB	-
	100	43	7211	C/DF	AC/DF	B/DF	C/DT	AC/DT	B/DT	C/DB	AC/DB	B/DB
	120	58	7311	C/DF	AC/DF	B/DF	C/DT	AC/DT	B/DT	C/DB	AC/DB	B/DB
60	95	36	7012	C/DF	AC/DF	-	C/DT	AC/DT	-	C/DB	AC/DB	-
	110	44	7212	C/DF	AC/DF	B/DF	C/DT	AC/DT	B/DT	C/DB	AC/DB	B/DB
	130	62	7312	C/DF	AC/DF	B/DF	C/DT	AC/DT	B/DT	C/DB	AC/DB	B/DB
65	100	36	7013	C/DF	AC/DF	-	C/DT	AC/DT	-	C/DB	AC/DB	-
	120	46	7213	C/DF	AC/DF	B/DF	C/DT	AC/DT	B/DT	C/DB	AC/DB	B/DB
70	110	40	7014	C/DF	AC/DF	-	C/DT	AC/DT	-	C/DB	AC/DB	-
	125	48	7214	C/DF	AC/DF	B/DF	C/DT	AC/DT	B/DT	C/DB	AC/DB	B/DB
	150	70	7314	C/DF	AC/DF	B/DF	C/DT	AC/DT	B/DT	C/DB	AC/DB	B/DB
75	130	50	7215	C/DF	AC/DF	B/DF	C/DT	AC/DT	B/DT	C/DB	AC/DB	B/DB
80	140	52	7216	C/DF	AC/DF	B/DF	C/DT	AC/DT	B/DT	C/DB	AC/DB	B/DB
90	160	60	7218	C/DF	AC/DF	B/DF	C/DT	AC/DT	B/DT	C/DB	AC/DB	B/DB
100	180	68	7220	C/DF	AC/DF	B/DF	C/DT	AC/DT	B/DT	C/DB	AC/DB	B/DB